

YT-870

Rotary Limit Switch Box Datasheet

ATEX, IECEx, CSA, CE



YTC Limit Switch

Type 4,4x

For General and Explosion
Proof Applications

Type 4,4x For General & Explosion Proof Applications YT-870



Limit Switch Rating

SPDT Mechanical Switch (M) (standard)	AC 125v 5A / 250v 3A
	DC 125v 0.4A / 250v 0.2A
	DC 30v 4A, 14v 5A, 8v 5A
DPDT Mechanical Switch (D) (non-standard)	AC 125v or 250v 10A
	DC 125v 0.5A / 250v 0.25A
Inductive Proximity Sensor (P) (non-standard)	DC 12~24v / NPN Type

Design Features

- ATEX, IECEx, CE
- CSA Certified for both US and Canada.
 - Class I, Zone 1, AEx db IIC T6
 - Class II, Div. 1, Groups E, F and G
 - Ex tb IIIC T85°C
 - Zone 21, AEx tb IIIC T85°C
 - Type 4, 4x, IP67
- 2-SPDT Mechanical Switches
- 8 Point Terminal Strip
- Aluminum Housing
- Polyester Power Coating
- Ambient Temperature -20 to 60°C (-4 to 140°F)
- Weight: 3.3 lbs
- Standard Mounting: NAMUR
- Use with ABZ, Quadrant and Sharpe Actuators

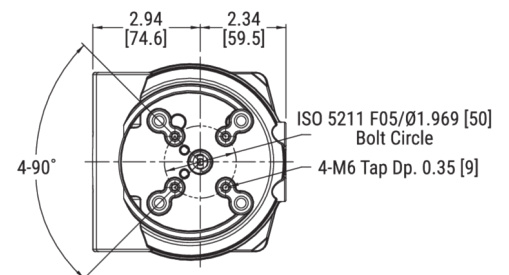
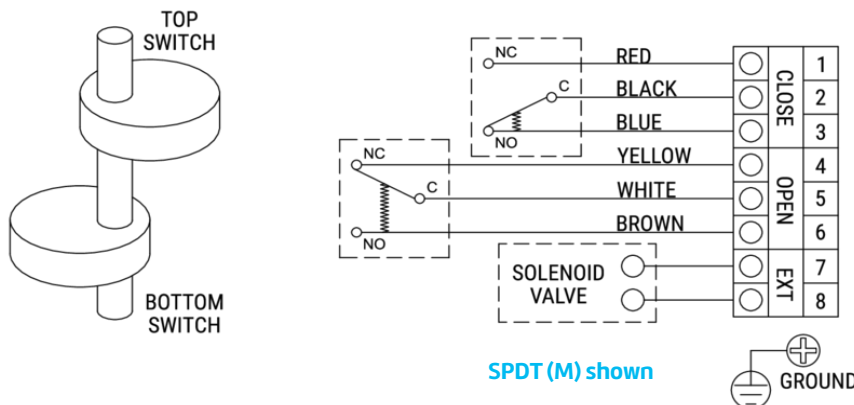
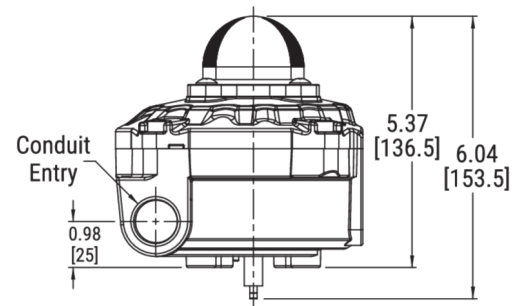
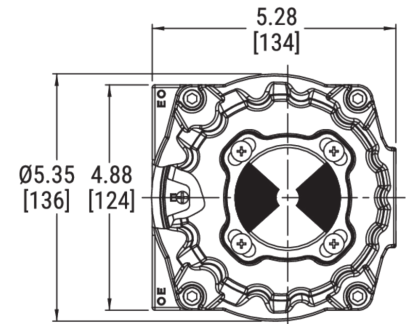

*Inches [millimeters]

Type 4, 4x For General & Explosion Proof Applications YT-870



Example: YT-870M100

A Type 4, 4X, explosion proof limit switch box with (2) Mechanical SPDT switches, 3/4" threaded conduit, no bracket, is: YT-870M100.

YT-870	M	1	0	0
Series	Switch Type	Conduit Thread	Bracket Type	Suffix / Option
YT-870	M Mechanical 2 S-SPDT	1 3/4" NPT	0 No Bracket	0
	<i>Non-Standard</i>	<i>Non-Standard</i>	<i>Non-Standard Ordered Separately See Page 4</i>	0 None
	P Inductive Proximity Sensor 2	2 G 3/4" BSP	ordered separately	1 4-20mA Transmitter
	D Mechanical 2-DPDT	3 M20 x 1.5 pitch	1 ST-1 (30x90/H20)	
		4 1/2" NPT	2 ST-2 (30x80/H30)	
			3 ST-3 (30x130/H30)	
			4 ST-4 (30x130/H50)	

Type 4, 4x For General & Explosion Proof Applications YT-870

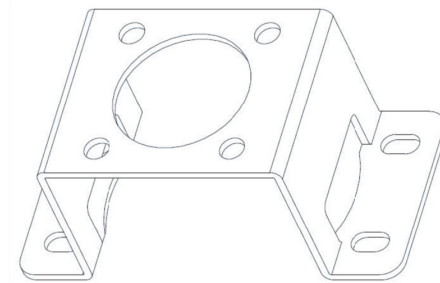

Actuator Mounting Brackets – Ordered Separately

ASC Item Number	Brand	Series	Used with	Description
4350004810	ABZ	Series 227 Series 228	50-115 [DA/SR] 20-300 [DA/SR]	30mm x 80mm mounting pattern 20mm actuator shaft height [ST-1] * X40 add required part 435019960
	QUADRANT	Series C	125-11000 [DA/SR]	
	SHARPE	Series SPNII Series 4x4	50-100 [DA/SR] X40 * - X115	
4350004812	ABZ	Series 227 Series 228	NONE	30mm x 80mm mounting pattern 30mm actuator shaft height [ST-2]
	QUADRANT	Series C	NONE	
	SHARPE	Series SPNII Series 4x4	115-160 [DA/SR] NONE	
4350004814	ABZ	Series 227 Series 228	125-270 [DA /SR] 500-3500 [DA/SR]	30mm x 130mm mount pattern 30mm actuator shaft height [ST-3]
	QUADRANT	Series C	NONE	
	SHARPE	Series SPNII Series 4x4	180-200 & 350 [DA /SR] NONE	
4350004816	ABZ	Series 227 Series 228	NONE NONE	30mm x 130mm mounting pattern 50mm actuator shaft height [ST-4]
	QUADRANT	Series C	NONE	
	SHARPE	Series SPNII Series 4x4	240-350 [DA/SR] NONE	

About ASC Engineered Solutions

ASC Engineered Solutions connects high-quality products with advanced technology, service, and support. With nearly 2,000 employees, the company's extensive portfolio of precision-engineered piping support, valves and connections provides products to professionals across industries, such as commercial and residential construction, industrial, fire protection, and oil and gas. Its portfolio of leading brands includes ABZ Valve®, AFCON®, Anvil®, Anvil EPS, Basic-PSA, Beck®, Catawissa, Cooplet®, FlexHead®, FPPI®, Gruvlok®, J.B. Smith, Merit®, NAP®, Quadrant®, SCI®, Sharpe®, SPF®, SprinkFLEX®, Trenton Pipe, VEP, and WARDFlex®. With headquarters in Oak Brook, IL, ASC also has ISO 9001:2015 certified production facilities in PA, TN, IL, TX, AL, KS, and RI.



asc-es.com

Building Connections That Last™

FC-DS-ABZ YT-870-Limit-Switches-v03 20260205

